

FR-D700 Variable Frequency Drive

World-class FA Products

FLEXIBLE COMPACT RELIABLE



Simple, time-saving startup



Flexible and versatile in application



Space saving installation due to compact design



Higher energy savings with the OEC function

FR-D700 | 0.4 kW to 7.5 kW

Simple Operation

- Simple cabling
- Easy para-meterisation
- Integrated control unit
- RJ 45 port support optional alpha-numeric keypad



Flexible Concept

- Compact installation
- Simple network connection
- Short service time
- Failure safety with self-diagnostics



More Standard Function

- Sensorless vector control
- Auto tuning
- High overload capacity
- Integrated brake chopper
- Password protected
- Traverse function

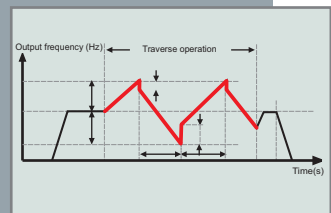

Simple To Maintain

- Easy to replace cooling fan
- No maintenance needed for 10 years
- Self diagnostic warnings for key internal components





SMART ATTRIBUTES

- Available in 240V / 1Ø upto 3HP & 480V / 3Ø upto 10HP
- Sensorless vector control makes it possible to achieve exceptional speed and torque performance
- Auto tuning function that can read out all the parameters needed for the motor
- Entire range with built-in brake chopper
- Standard RS485 serial communications supporting Modbus RTU
- Sink / Source selectable I/O
- Built-in PID control
- Digital I/P : 5 nos.
- Digital O/P : 2 nos.
- Analog I/P : 2 nos. 0-5 / 10 VDC & 4-20 mA DC
- Analog O/P : 0-10 VDC
- Higher energy savings with the OEC function
- Overload capacity – 150% for 60 seconds & 200% for 0.5 seconds
- Life check function

ENHANCED FEATURES

- Password protected
- Dancer control PID
- Traverse function
- kWh display
- Power failure stop function

TOP-NOTCH TECHNICAL CHARACTERISTICS

Long-life Design

- 10 year design life
- Fan failure detection

Components	Life
Cooling fan	10 years
Main circuit smoothing capacitor	10 years
Printed board smoothing capacitor	10 years

Special Functions for Regenerative Applications

- Built-in chopper for effective braking
- Regeneration avoidance function for tripless performance

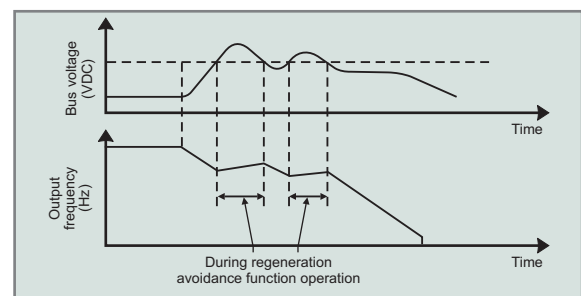

Flexible Operating Mode

Operation mode selection according to combination of the start command and speed command

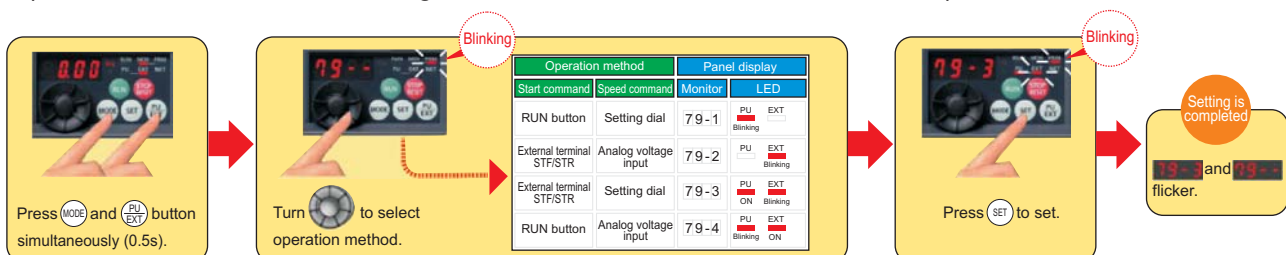

SPECIFICATIONS

Type		Rated O/P Current [A]	Rated Motor Capacity [kW]	WxHxD (mm)
200 V Type	FR-D720S-025-EC	2.5	0.4	68 x 128 x 142.5
	FR-D720S-042-EC	4.2	0.75	68 x 128 x 162.5
	FR-D720S-070-EC	7.0	1.5	108 x 128 x 155.5
	FR-D720S-100-EC	10.0	2.2	140 x 150 x 155.5
400 V Type	FR-D740-012-EC	1.2	0.4	108 x 128 x 129.5
	FR-D740-022-EC	2.2	0.75	108 x 128 x 129.5
	FR-D740-036-EC	3.6	1.5	108 x 128 x 135.5
	FR-D74-050-EC	5.0	2.2	108 x 128 x 155.5
	FR-D740-080-EC	8.0	3.7	108 x 128 x 165.5
	FR-D740-120-EC	12	5.5	220 x 150 x 155
	FR-D740-160-EC	16	7.5	220 x 150 x 155

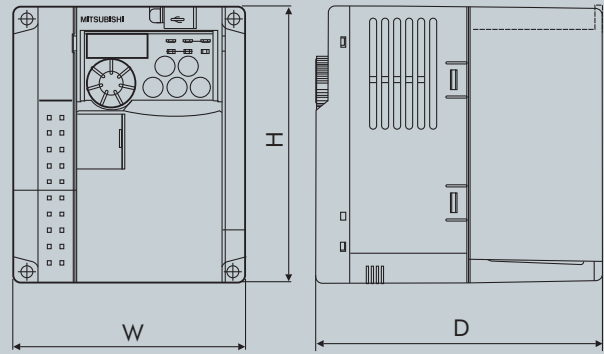

Operating Conditions	Specifications
Voltage	1-phase, 200-240 V (-15%, +10%) or 3-phase, 380-480 V (-15%, +10%)
Ambient temperature	-10°C to + 50°C (non-freezing)
Storage temperature	-20°C to + 65°C
Ambient humidity	Max. 90% relative humidity (non-condensing)
Altitude	Max. 1000m above sea level

Operating Conditions	Specifications
Protection	IP20
Shock resistance	10 G
Vibration resistance	Max. 0.6 G
Certifications	CE/UL/cUL/RoHS

Display Option	Description
FR-PA07	LED Display Unit



Textile



Conveyor



Pharma



Elevator



Mitsubishi Electric India Pvt. Ltd.
Factory Automation & Industrial Division

FAID Head Office: Emerald House, EL-3, J Block,
M.I.D.C. Bhosari, Pune - 411026, INDIA
Tel: +91-20-2710 2000 Fax: +91-20-2710 2100
Email: marketing.FA1@mei-india.com
Web: www.MitsubishiElectric.in

Pune | Mumbai | Vadodara | New Delhi | Hyderabad | Bangalore | Chennai